

# REEMPLACER UNE PORTE RELEVANTE LEROY MERLIN DELINIA

# ryk

Notice de montage

21115045

ET VOTRE CUISINE  
CHANGE DE VIE

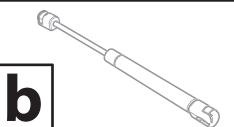
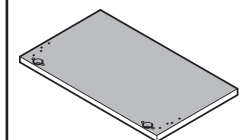

Option gabarit  
de perçage

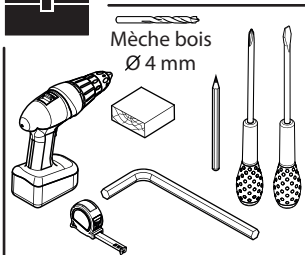
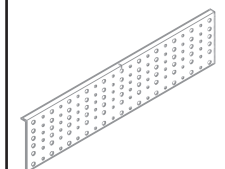

Mèche bois  
Ø 4 mm



## 1a Démontage de l'ancienne porte avec compas



Conserver les charnières et les  
compas de relevage.

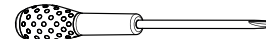
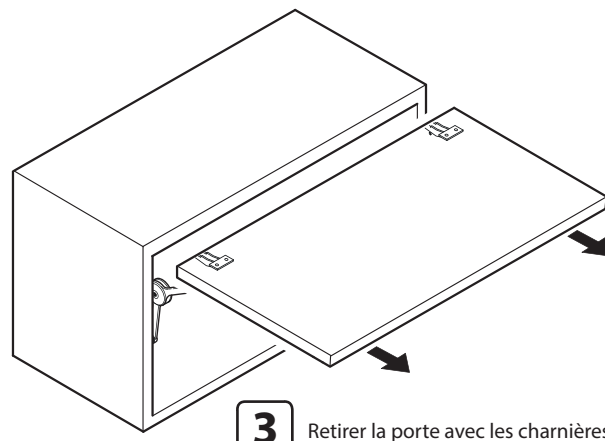
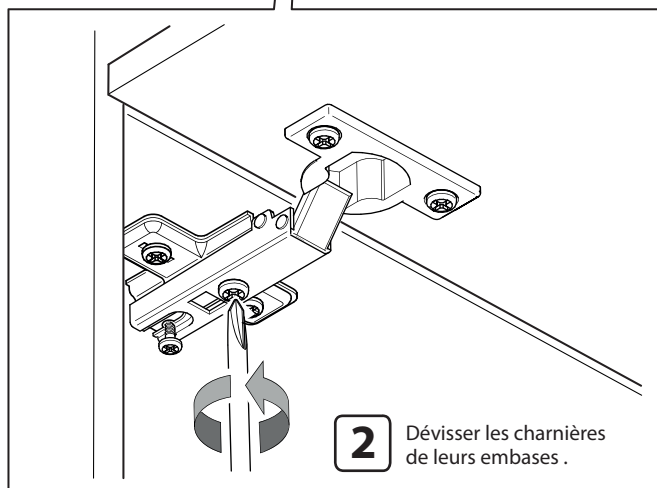
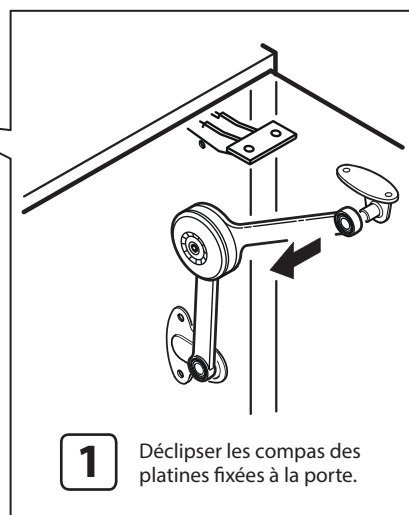
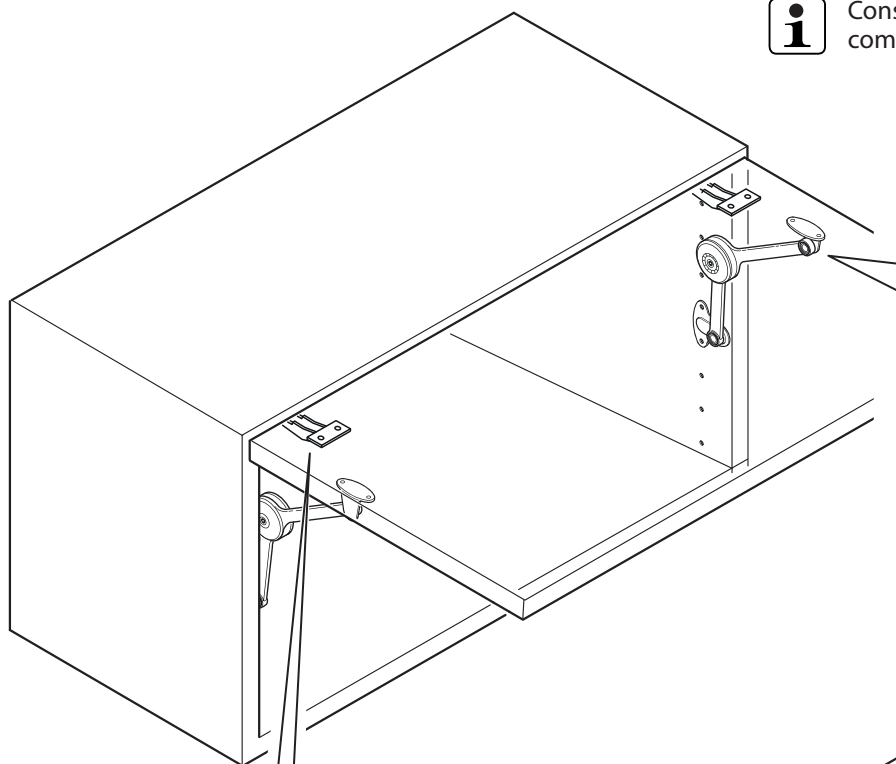

## 2a Démontage des charnières et des platines de la porte

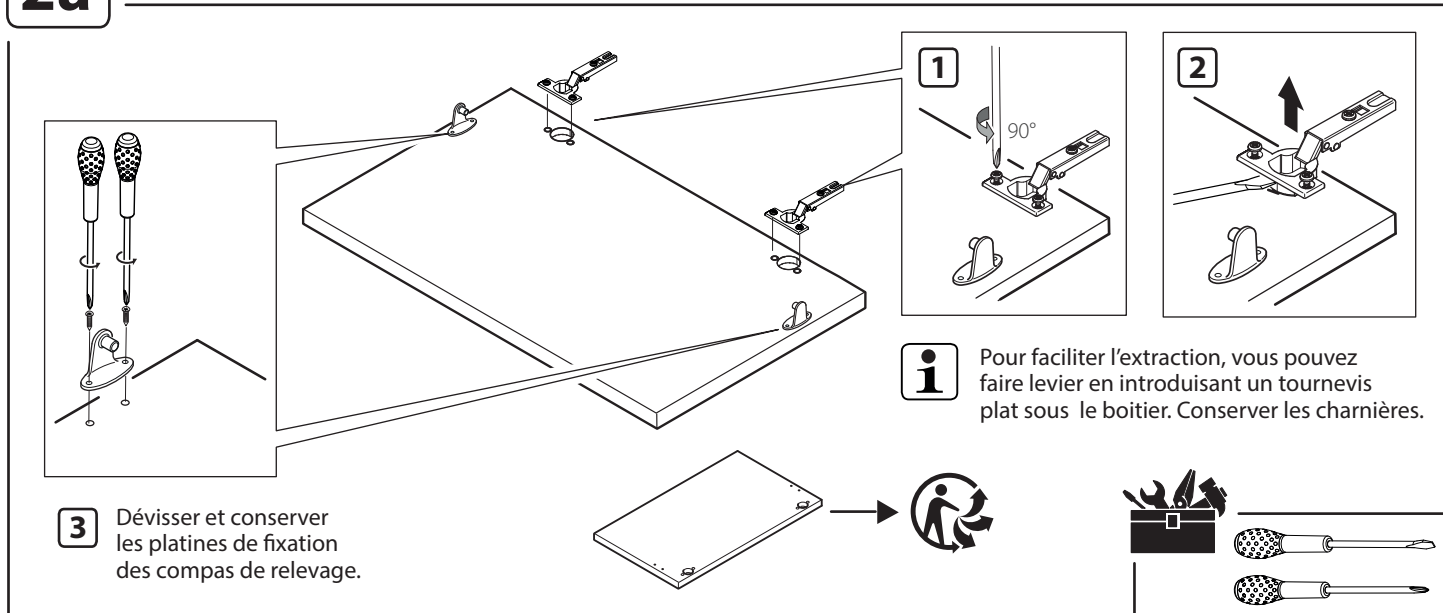

## 3a Montage des charnières et des platines sur la nouvelle la porte

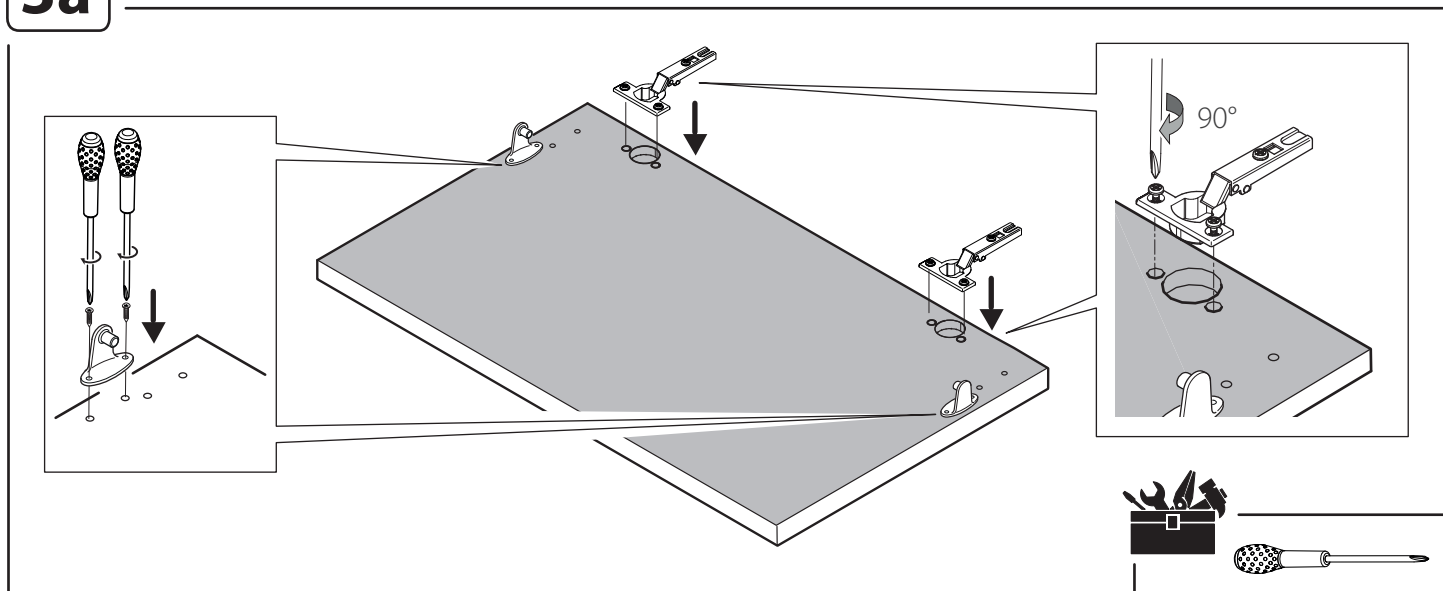

## 4a Montage de la nouvelle porte sur les embases

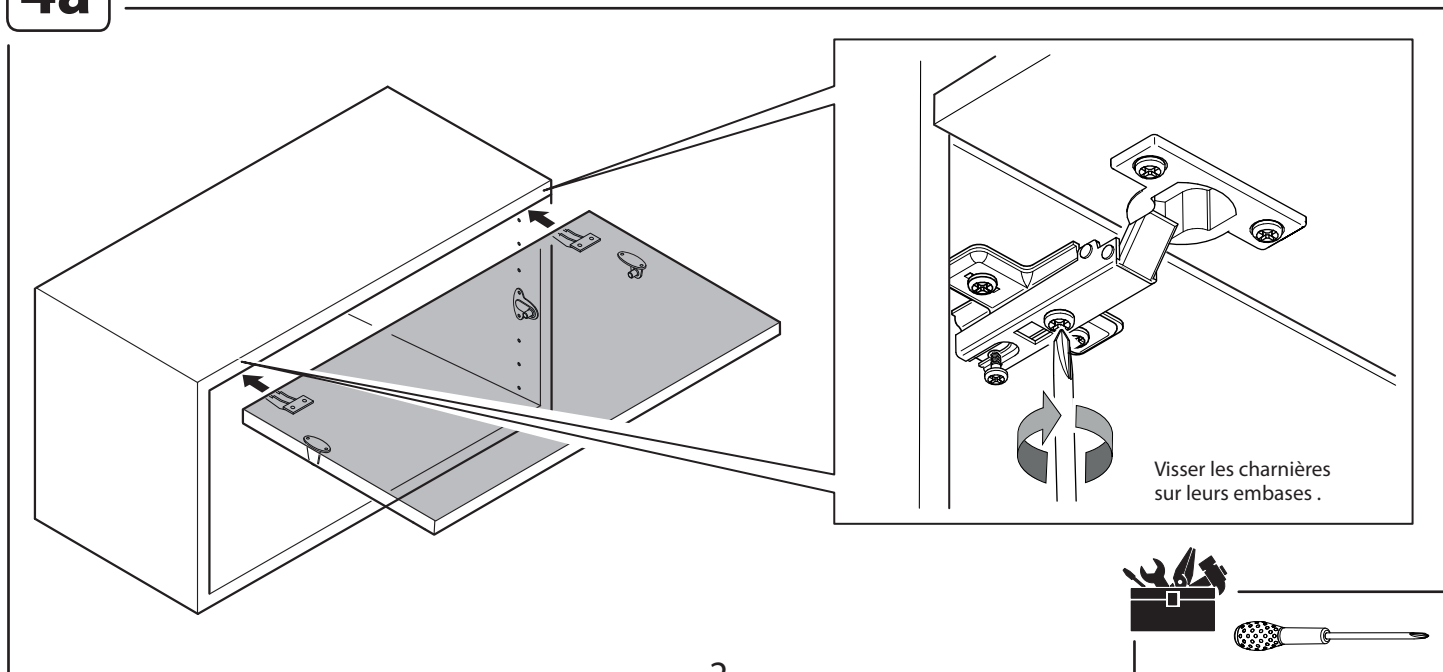

## 5a Montage des compas de porte

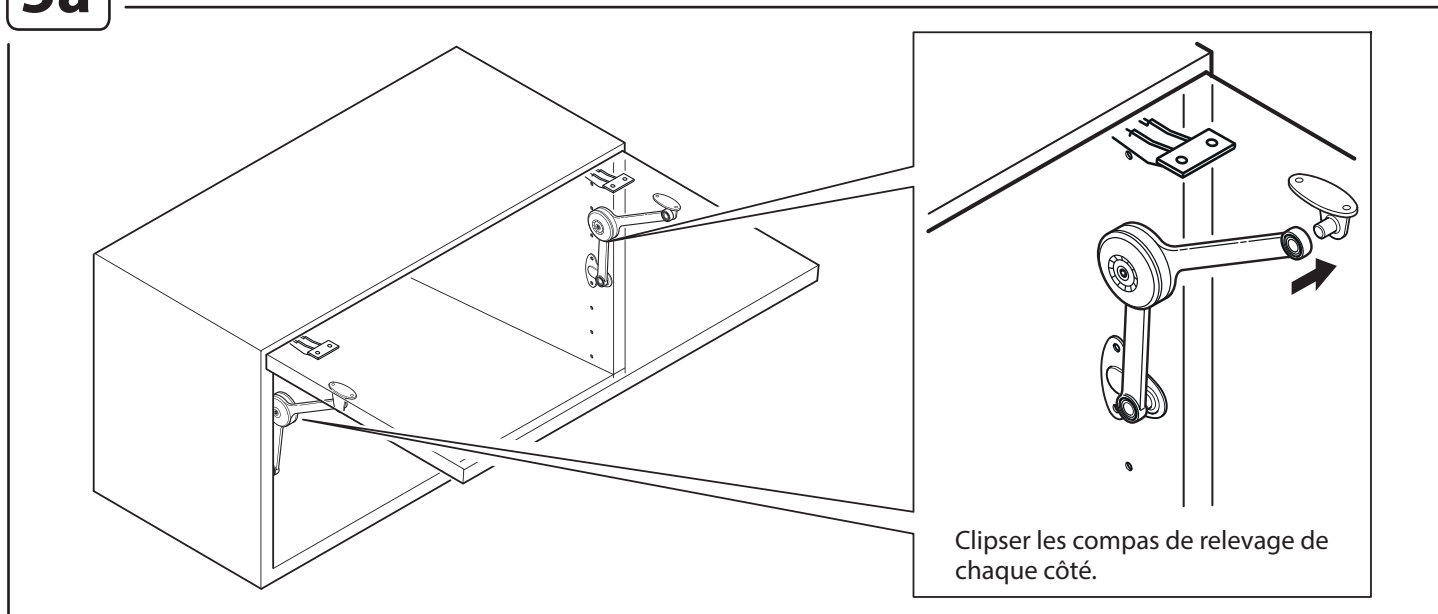

## 6a Mise en place de la poignée avec guide de perçage.

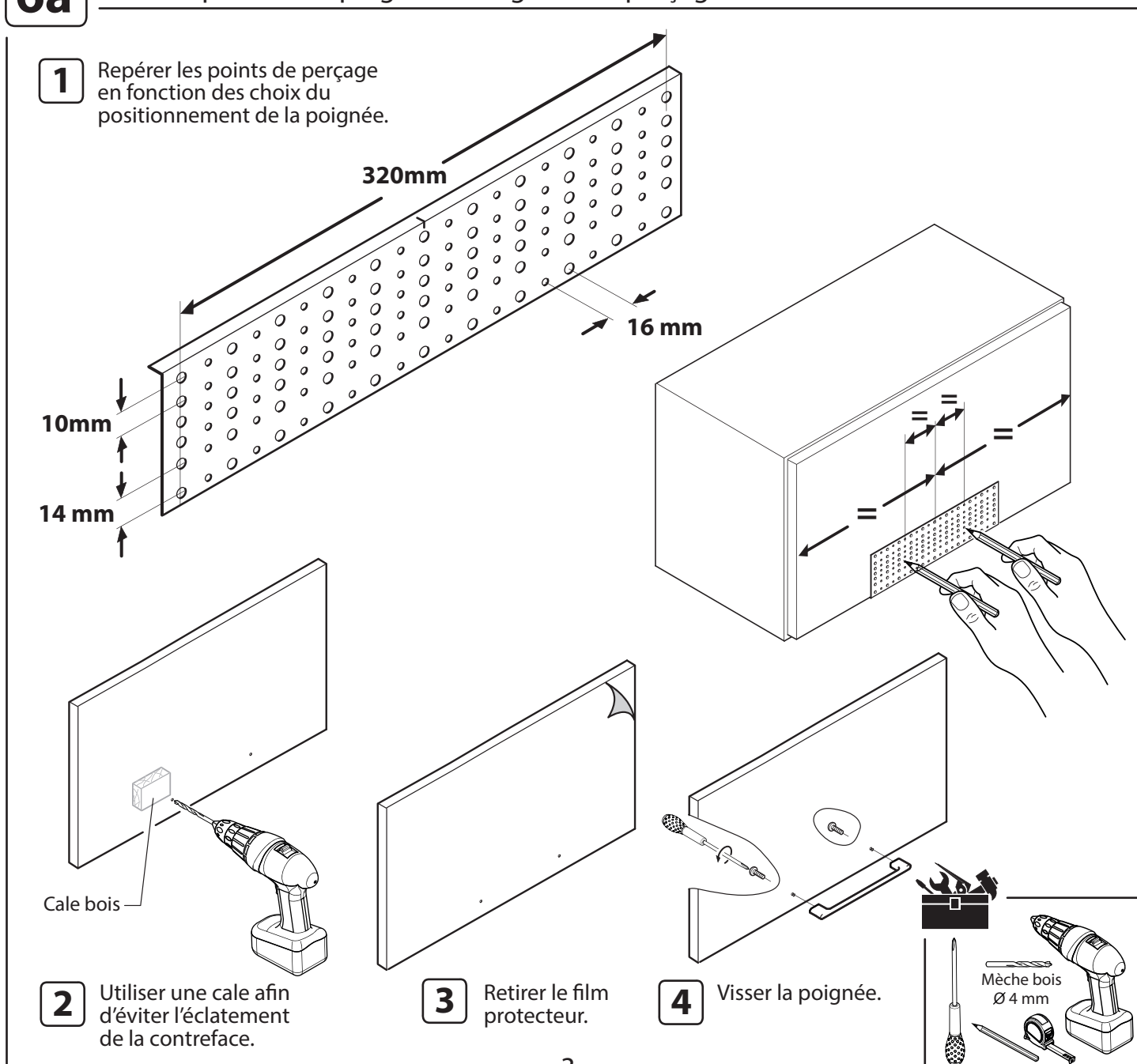

# 7a

## Réglages de la porte

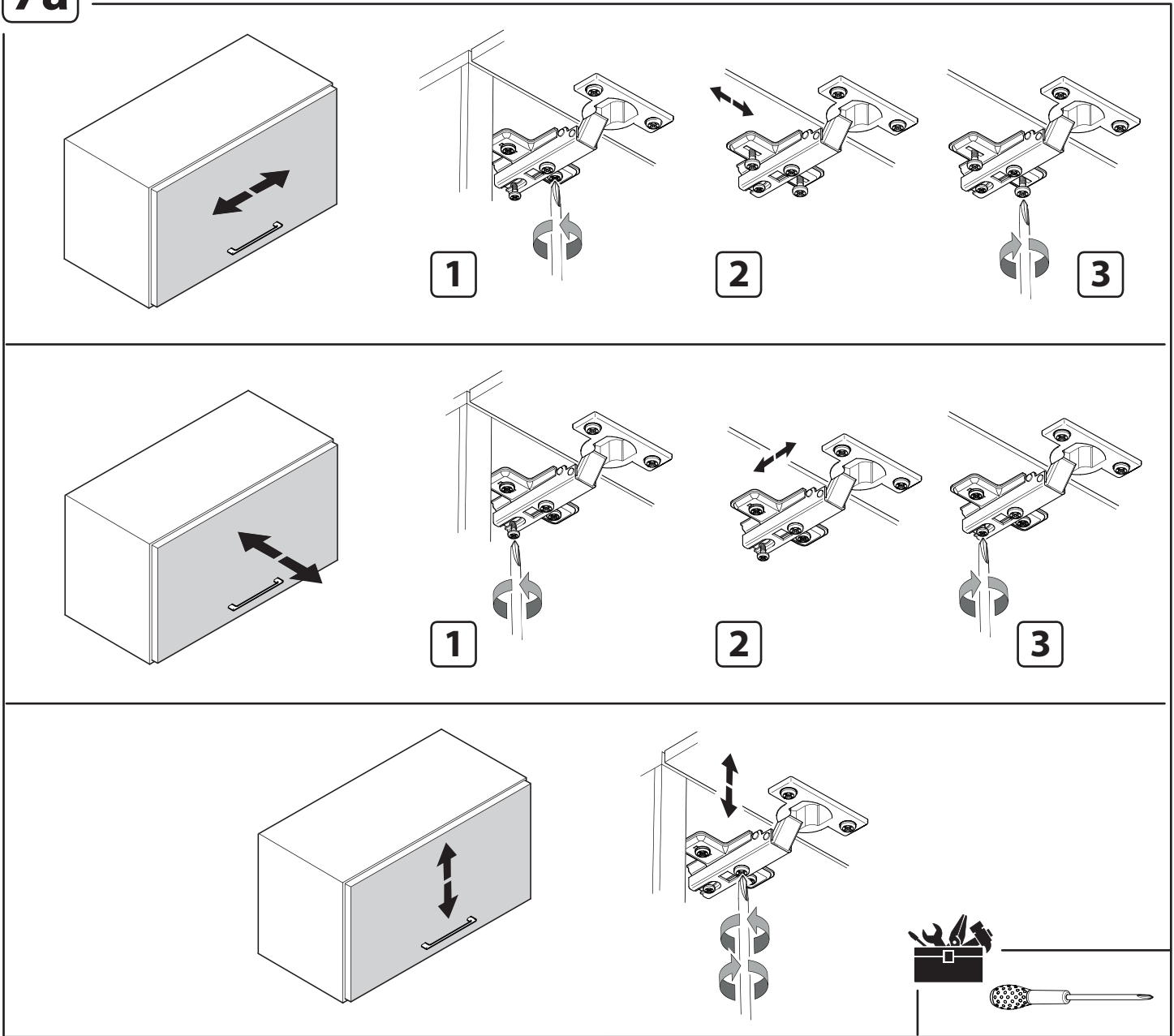

# 8a

## Réglages de la force d'ouverture et de fermeture des compas de la porte

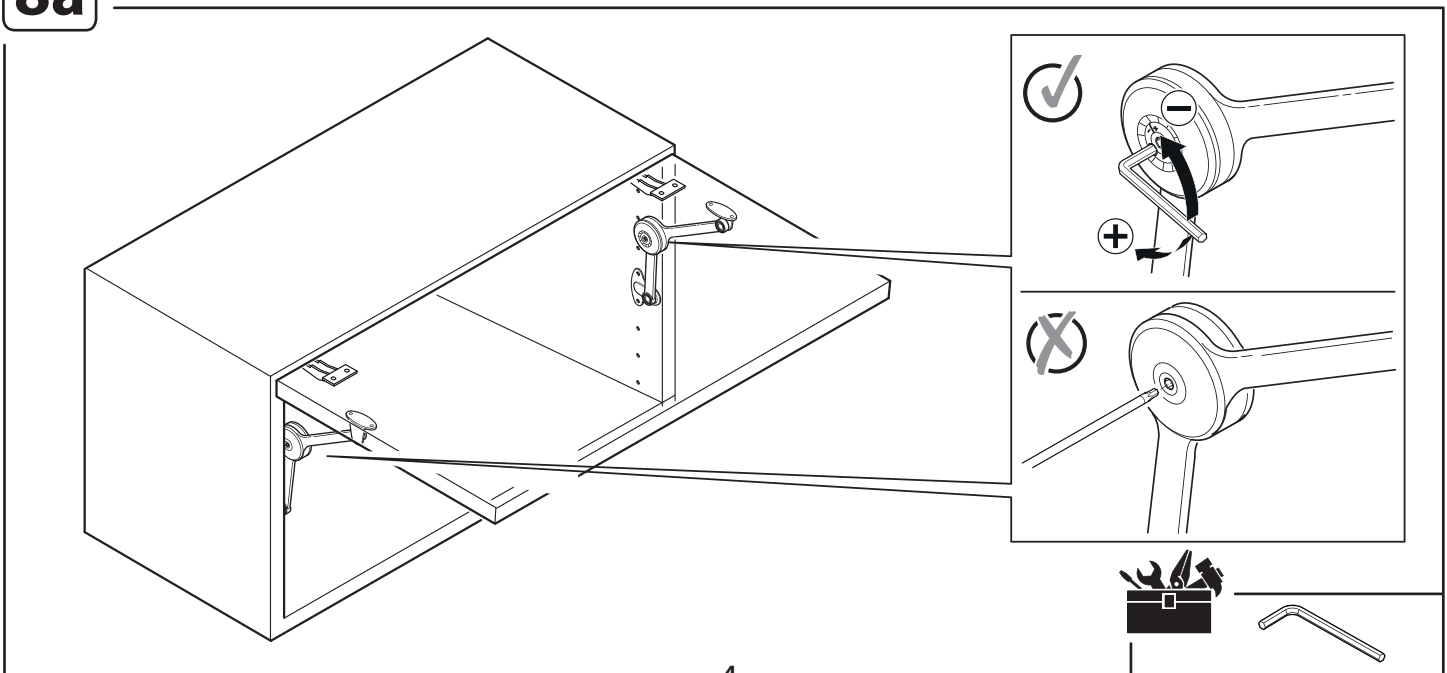

**1b**

# Démontage de l'ancienne porte avec vérins



Conserver les charnières et les vérins.

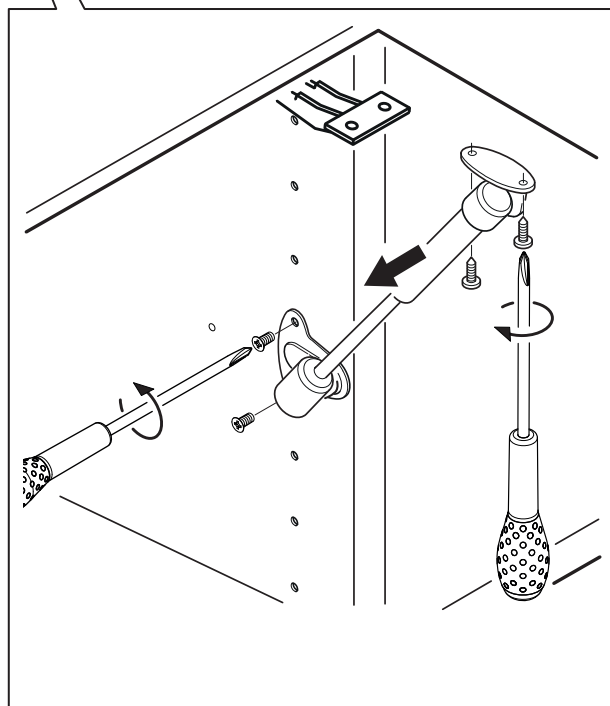
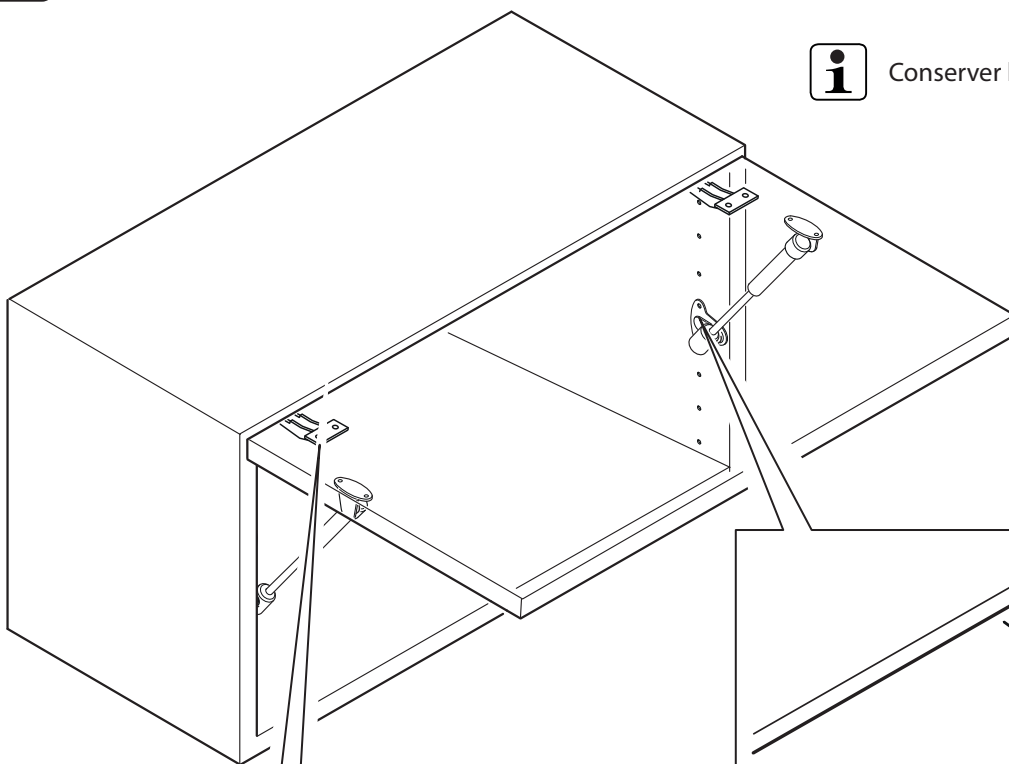

**1** Retirer les vérins à gaz en dévissant les platines de la porte et du caisson.

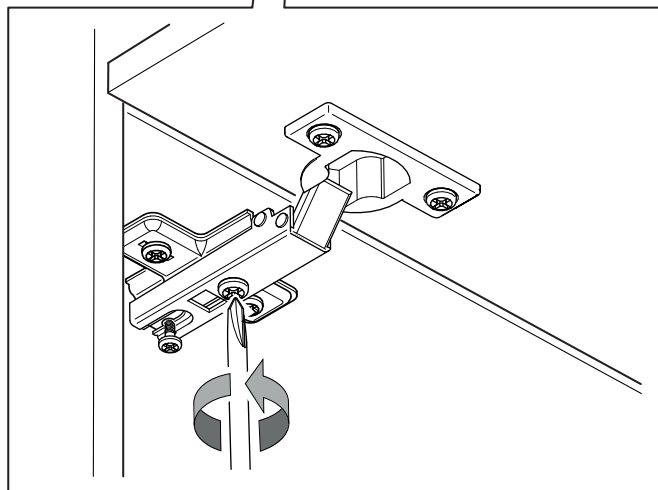

**2** Dévisser les charnières de leurs embases.

**3** Retirer la porte avec les charnières

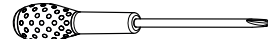
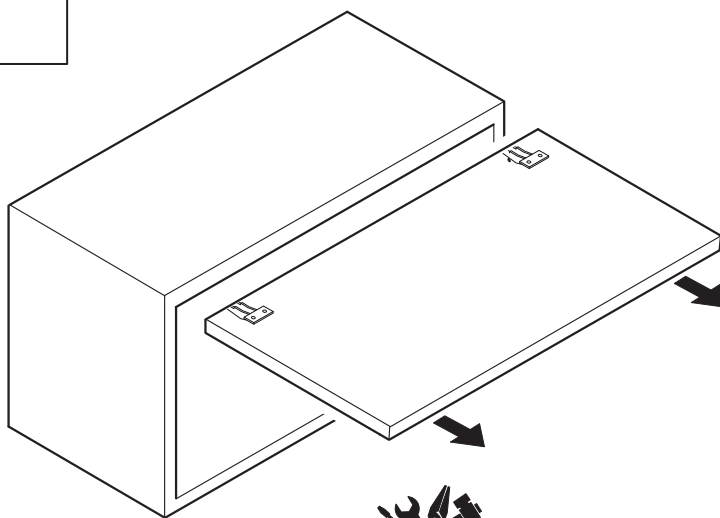

## 2b Démontage des charnières

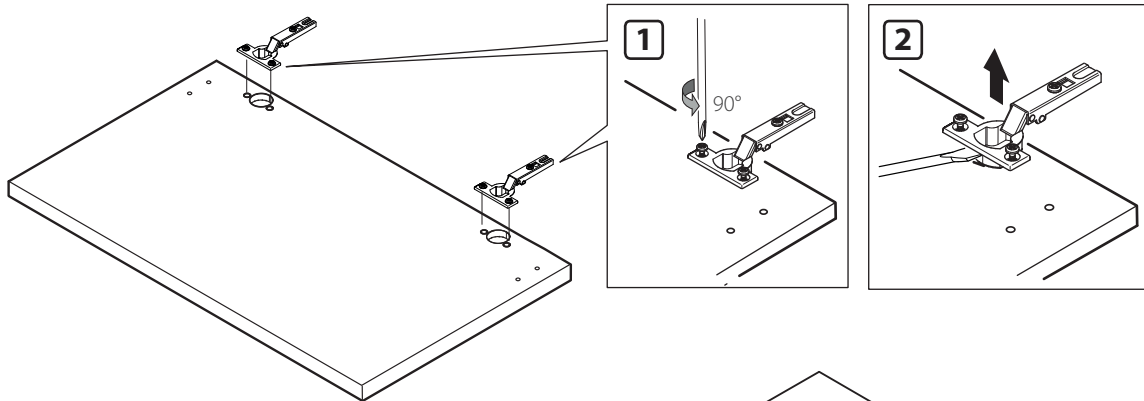

**i** Dévisser et conserver les charnières de porte.

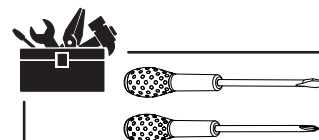

## 3b Montage des charnières sur la nouvelle la porte

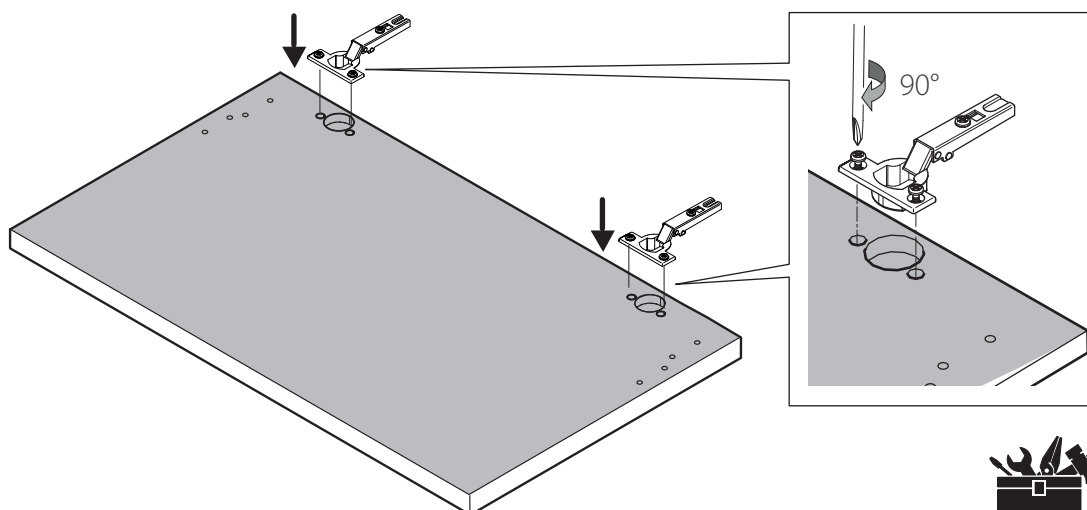

## 4b Montage des platines et des vérins sur la nouvelle porte

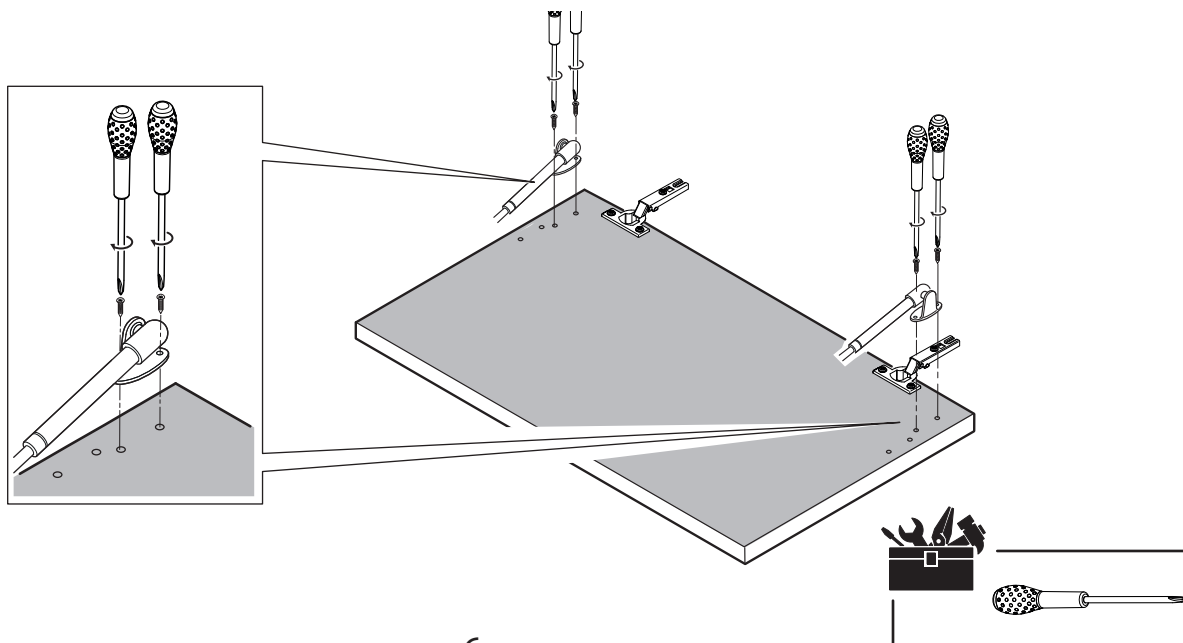

## 5b Montage de la nouvelle porte

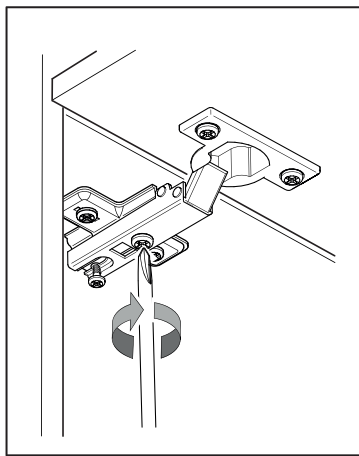

**1** Visser les charnières sur leurs embases.

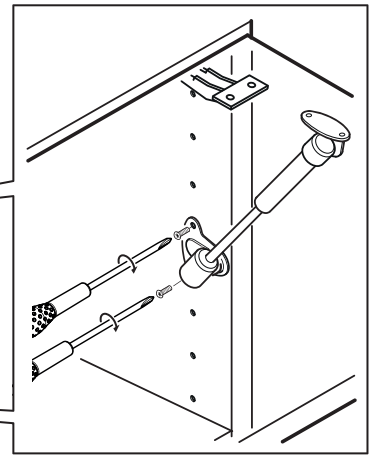
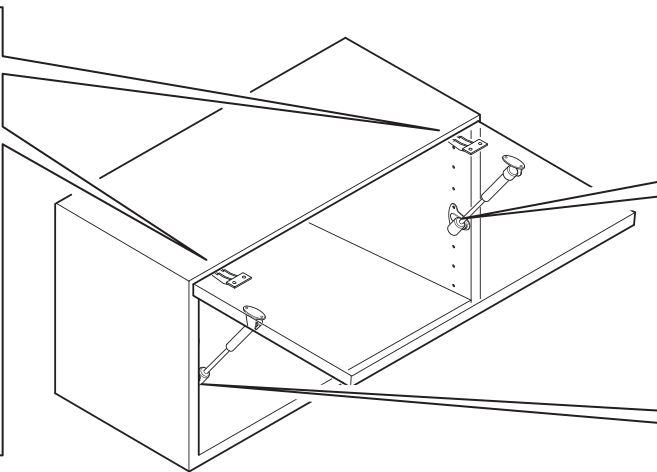

**2** Visser les vérins sur le caisson.

## 6b Mise en place de la poignée avec guide de perçage.

**1** Repérer les points de perçage en fonction des choix du positionnement de la poignée.

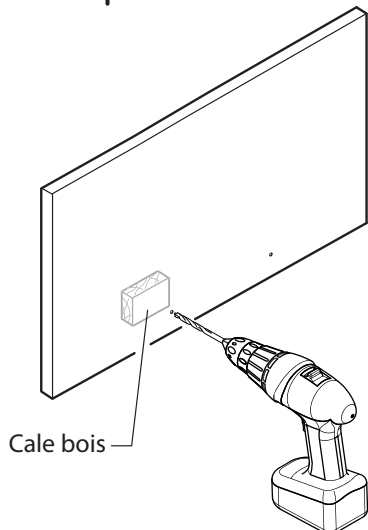
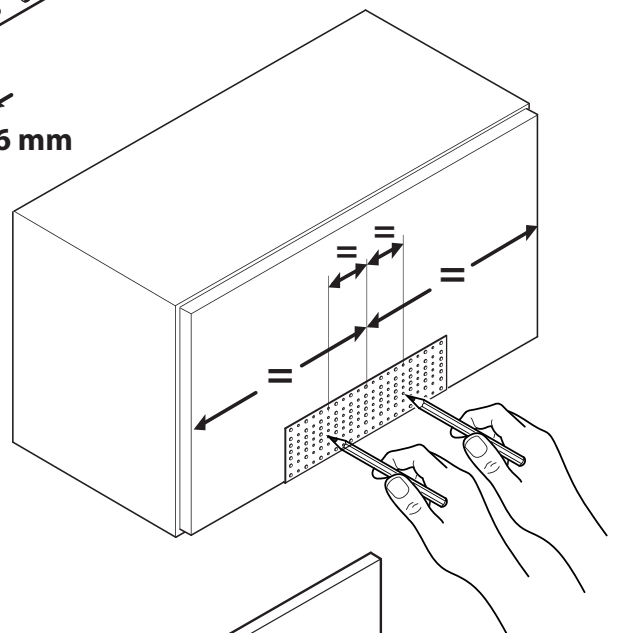
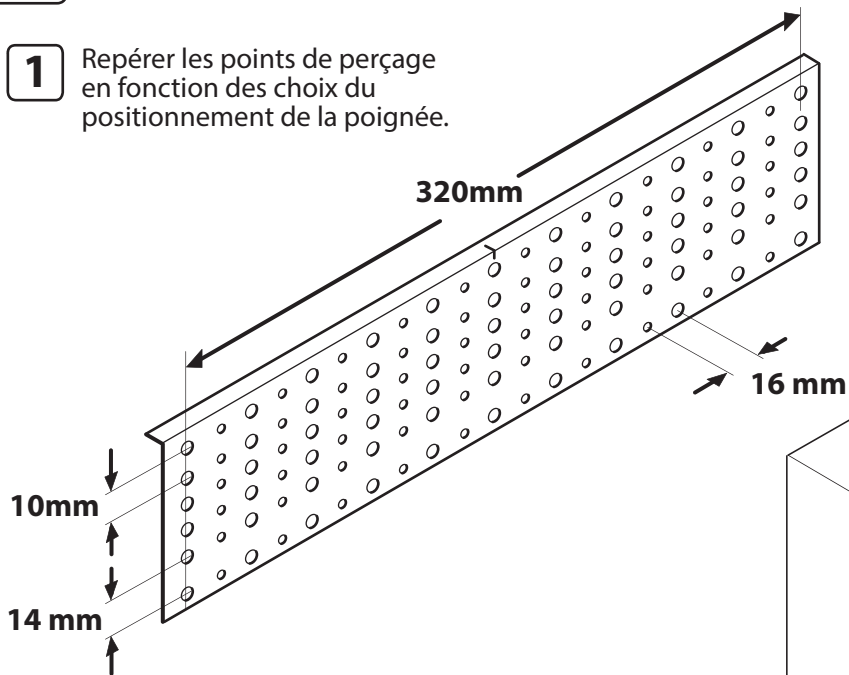

**2** Utiliser une cale afin d'éviter l'éclatement de la contreface.

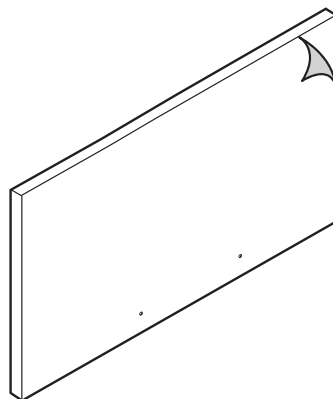

**3** Retirer le film protecteur.

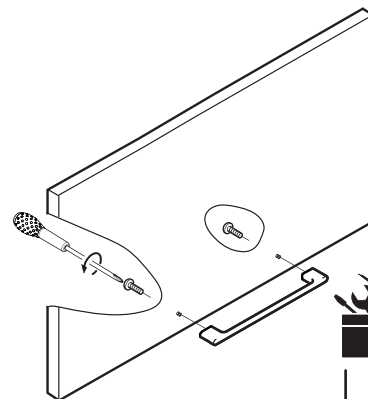

**4** Visser la poignée.

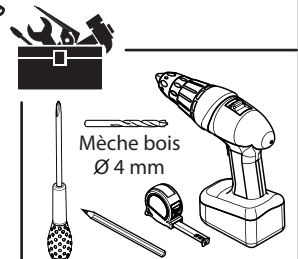

**7b**

## Réglages de la porte

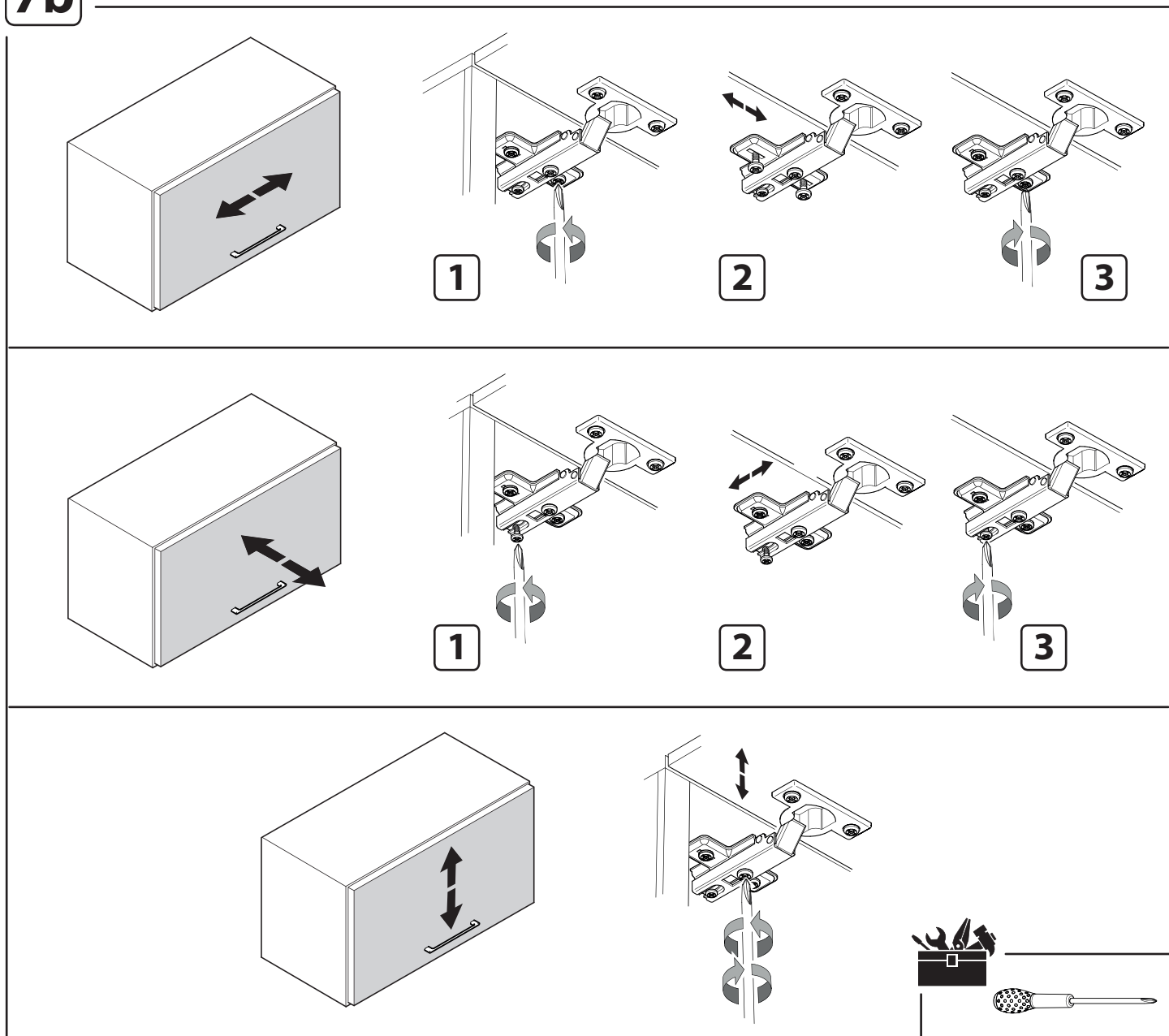

Vous n'êtes toujours  
pas sûr?  
Nous contacter sur  
le site :

[RELOOKYOURKITCHEN.COM](https://relookyourkitchen.com)

**ryk**  
ET VOTRE CURSUS  
CHANGE DE VIE



PARTICIPEZ AU RECYCLAGE  
DES MEUBLES. PLUS D'INFOS:  
**écomobilier**